

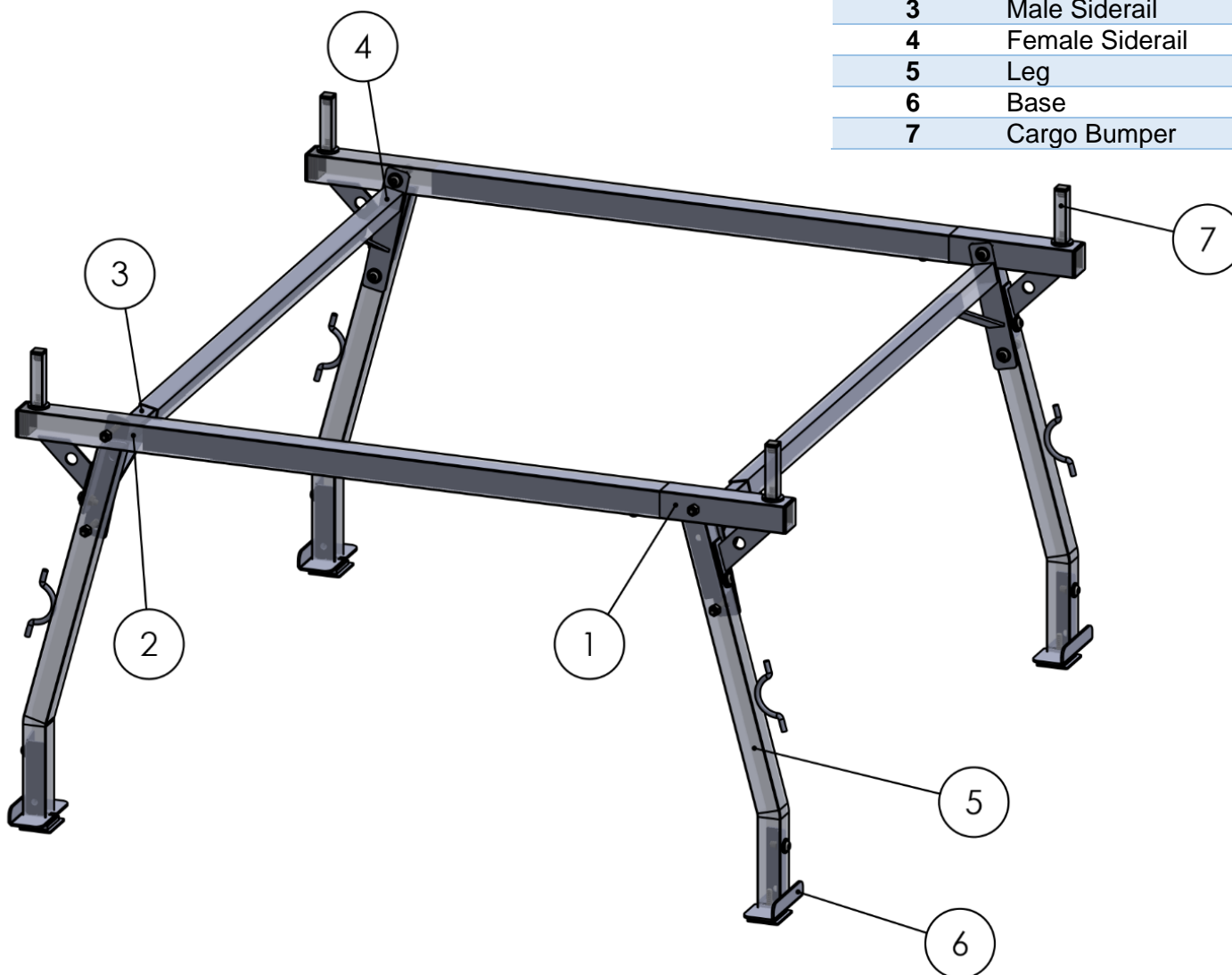

Stake Pocket Std. Rack (Ford / Dodge)

MADE IN THE USA

| Item NO. | Description | Qty. |
|----------|-----------------|------|
| 1 | Male Crossbar | 2 |
| 2 | Female Crossbar | 2 |
| 3 | Male Siderail | 2 |
| 4 | Female Siderail | 2 |
| 5 | Leg | 4 |
| 6 | Base | 4 |
| 7 | Cargo Bumper | 4 |





Stake Pocket Std. Rack (Ford / Dodge)

MADE IN THE USA

| Item NO. | Description | Qty. |
|----------|------------------------------------|------|
| 8 | Ford Stake Pocket Insert | 4 |
| 9 | 1.75" x 1.75" Crossbar End Cap | 4 |
| 10 | 3/8" – 16 x 1" Button Head Screw | 12 |
| 11 | 3/8" – 16 x 3/4" Button Head Screw | 4 |
| 12 | 3/8" – 16 x 2.5" Button Head Screw | 8 |
| 13 | 3/8" x 7/8" Metal Washer | 24 |
| 14 | 3/8" – 16 x 1.75" Carriage Bolt | 4 |
| 15 | 3/8" – 16 Nylon Lock Nut | 12 |
| 16 | Allen Wrench | 1 |

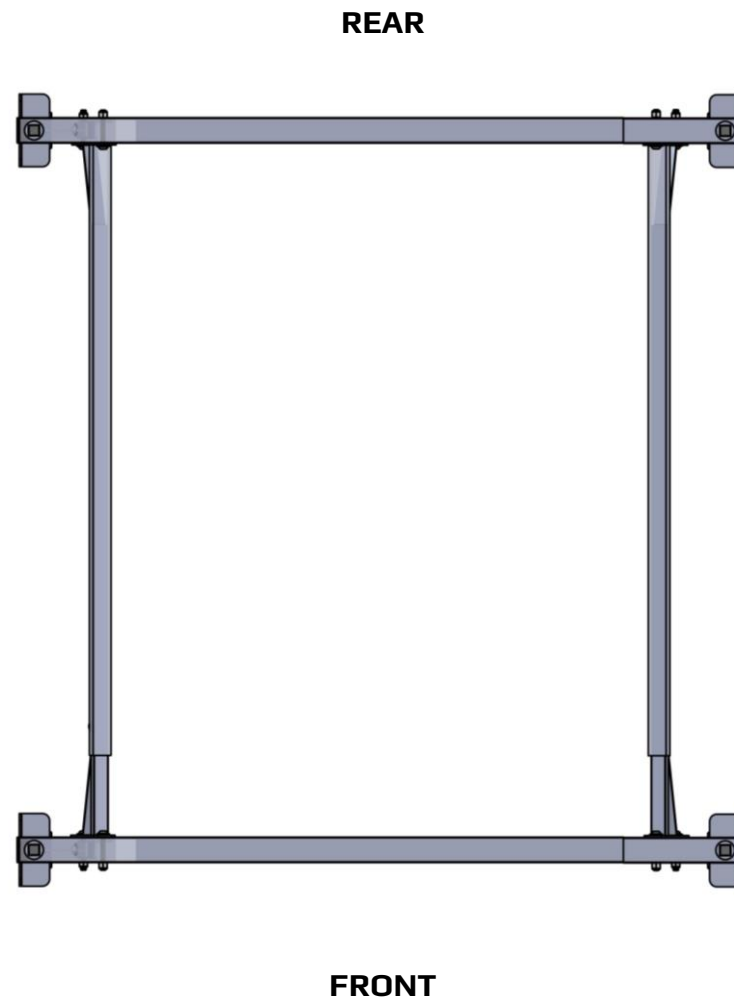
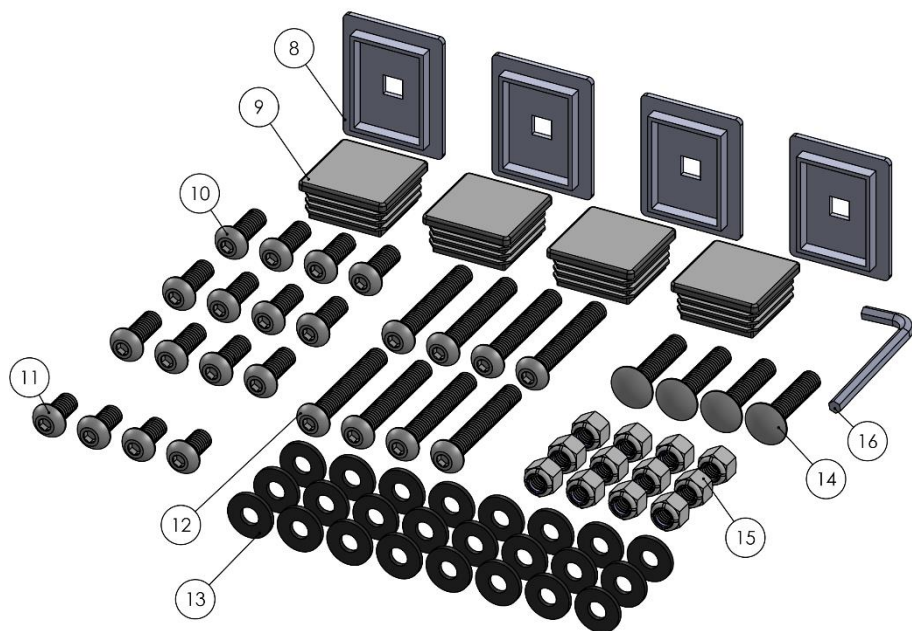

NOTICE: Ensure that the larger portion of the plate is fully seated inside the pocket and that the smaller raised portion of the plate is seated within the profile of the rectangular hole. It is critical that the raised portion fits within this profile and that no edge of the bottom plate is visible from above – even when jimmied. This will prevent the carriage bolt and the plate from spinning, sliding or coming apart. If you cannot seat the plate in accordance with these instructions, STOP, and contact customer service at 1-951-271-3498 before proceeding with installation.

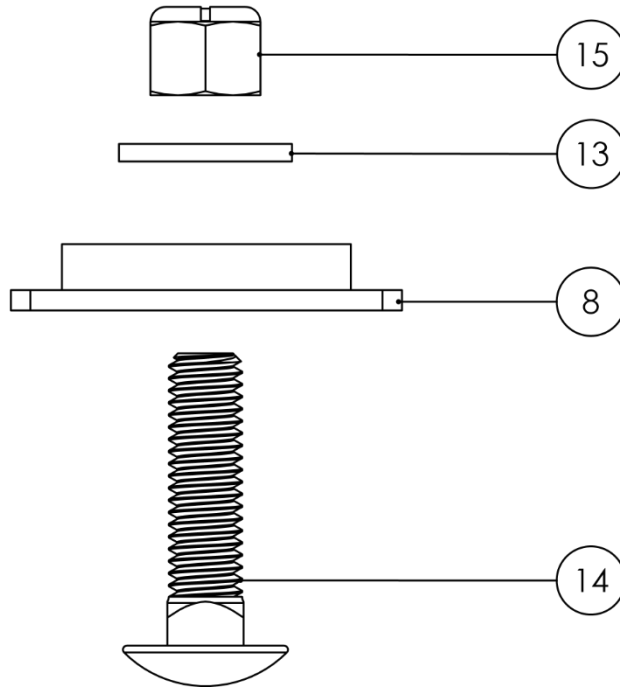

Figure 1

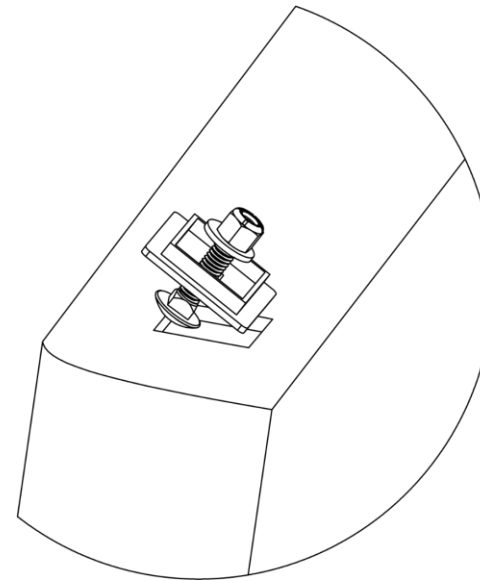

Figure 2

1. **Install the Stake Pocket Insert Plates.** To install the Bases (Item No. 6) you must first install the Stake Pocket Insert Plates (Item No. 8). The parts of this bolt assembly will be put together in the order as shown in Figure 1. Combine these parts but allow space for the Base (Item No. 6) by leaving the Lock Nut (Item No. 15) at the end of the Carriage Bolt (Item No. 14). Once this bolt assembly has been put together, insert the Stake Pocket Insert Plate (Item No. 8) into your truck's stake pocket by tilting the plate diagonally.

2. **Install the Rack Bases.** Examine the Bases (Item No. 6) and notice the upright flange. The base must be positioned so that this flange is on the outside of the bed as shown in Figure 3. To install the base, place it on the truck bedrail and position it so that the opening found on the bottom of the base is aligned with the bolt projecting up out of the stake pocket. As shown in Figure 4, slide the base forward so that its bottom can be clasped between the Carriage Bolt (Item No. 14), the Washer (Item No. 13) and the Lock Nut (Item No. 15). Once the base has been pushed forward, use a wrench to tighten the assembly until the washer and lock nut are in contact with the bottom of the base. **DON'T forget to apply a little grease to the screws before tightening or it may be hard to remove the nuts later.**

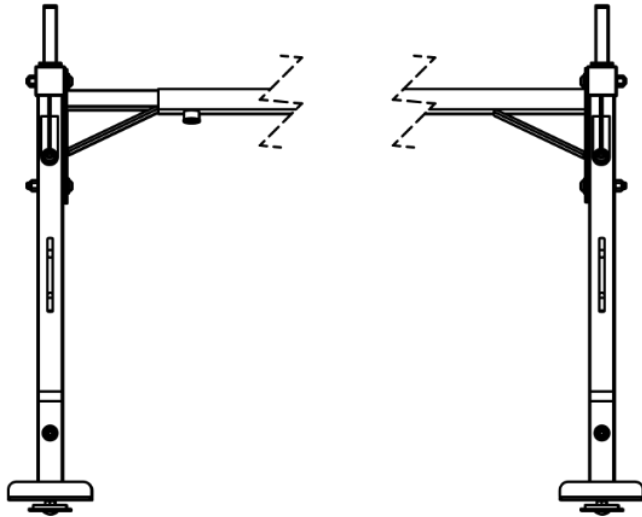

Figure 3

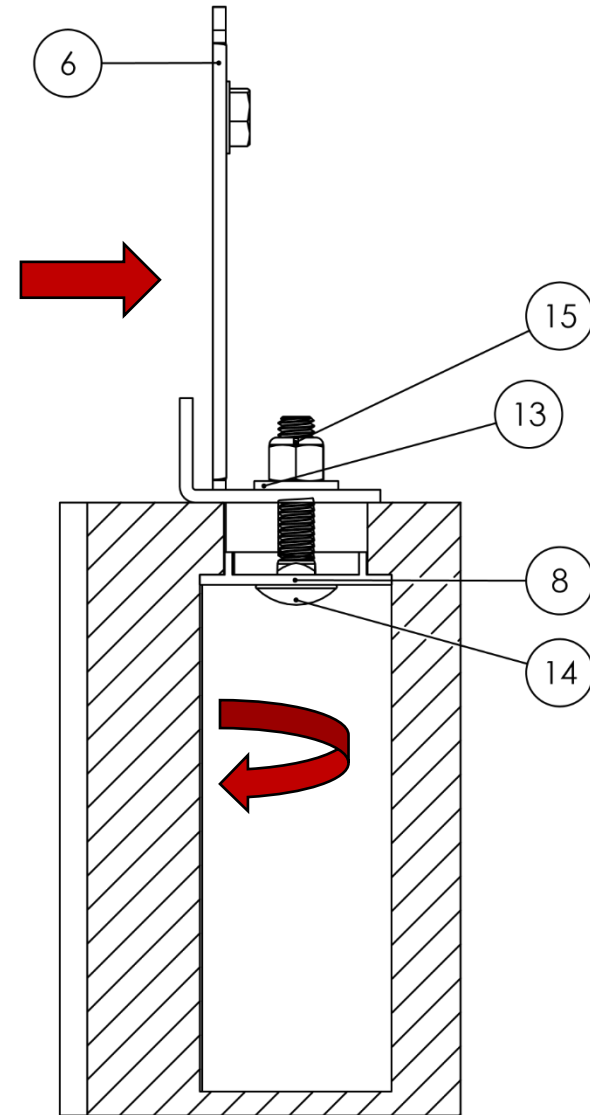

Figure 4

3. **Attach the Legs to the Bases.** Examine the Legs (**Item No. 5**) and notice the holes drilled on the outside of each leg. As shown in **Figure 5**, slide the leg down and align it so that its hole lines up concentrically with the hole found on the Base (**Item No. 6**).

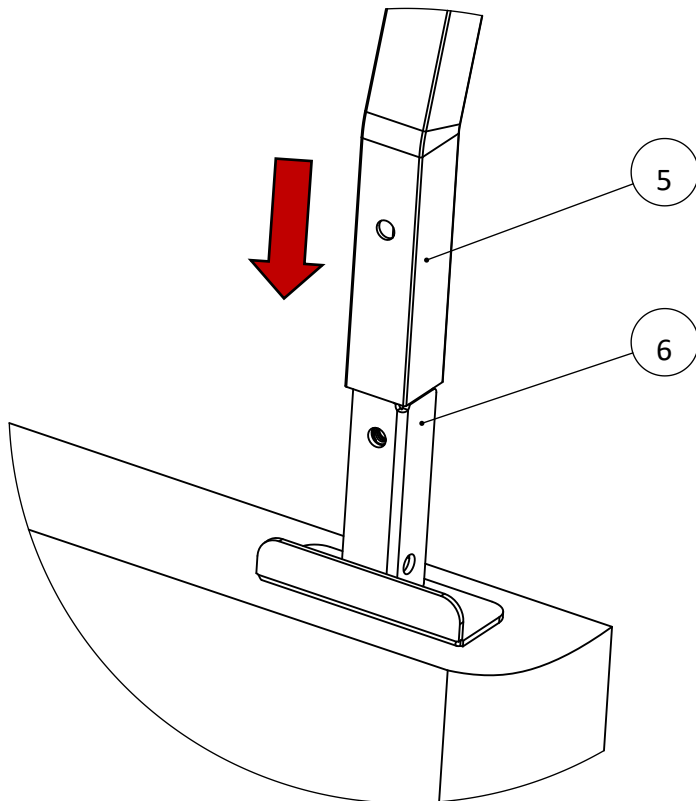

Figure 5

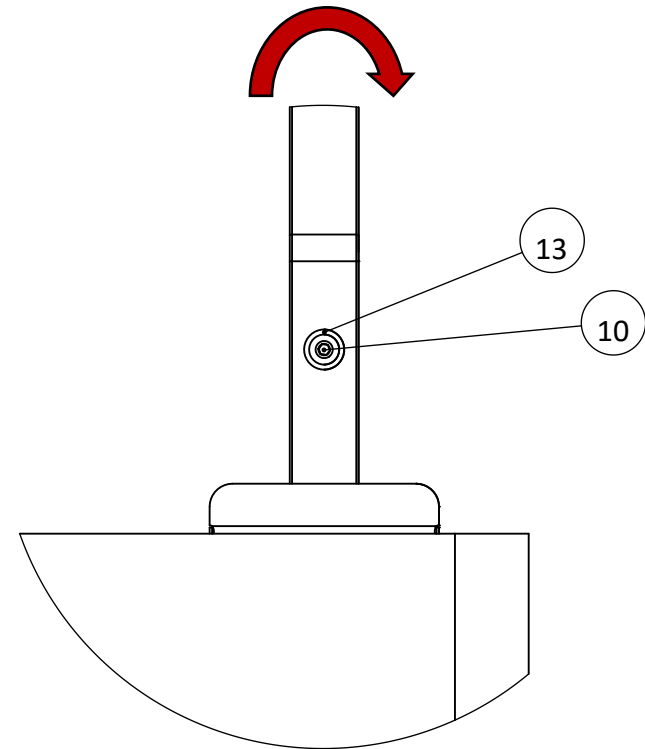

Figure 6

3. Secure the parts together by threading a 1" Button Head Cap Screw (**Item No. 10**) with Washer (**Item No. 13**) into the holes. To allow for easier assembly, lightly tighten the screws for now.

4. **Assemble the Crossbars.** Slide both Male Crossbars (Item No. 1) into the Female Crossbars (Item No. 2).

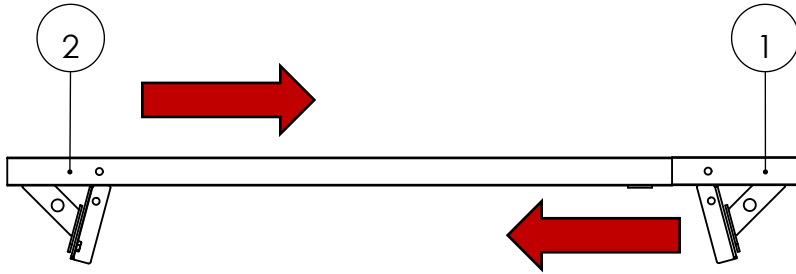

Figure 7

6. **Secure the Crossbars.** Once within the Legs (Item No. 5), lock the Crossbars' position by threading a $\frac{3}{4}$ " Button Head Screw (Item No. 11) into the position shown in Figure 9. This screw adds to the stability of the Crossbars.

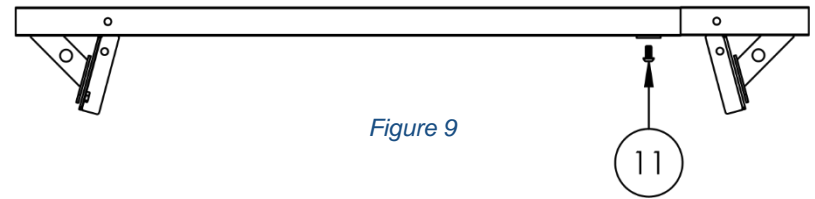

Figure 9

5. **Attach the Crossbars onto the Legs.** Slide the Crossbars (Item No. 1 & 2) into the rack's Legs (Item No. 5).

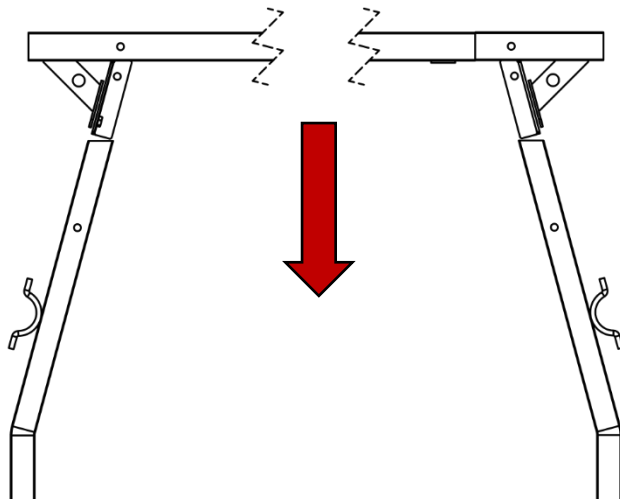

Figure 8

7. **Secure the Crossbars onto the Legs.** Notice the concentric holes found on the side of the Legs. Secure the parts together by threading a 1" Button Head Cap Screw (Item No. 10) with Washer (Item No. 13) into the holes.

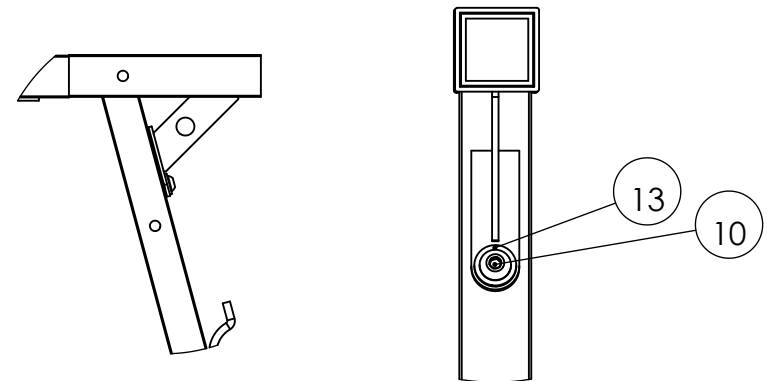

Figure 10

8. **Assemble the Siderails.** Slide both Male Siderails (Item No. 3) into the Female Siderails (Item No. 4).

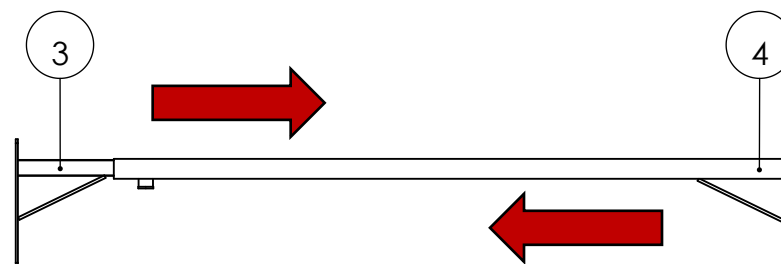

Figure 11

9. **Secure the Siderails onto the Legs.** Locate the holes found on the back of the Crossbars and the Legs. These holes will be used to secure the Siderails onto the rack. As shown in Figure 12 thread (2) 2.5" Button Head Screws (Item No. 12) with Metal Washers (Item No. 13) and Locknuts (Item No. 15) at every corner.

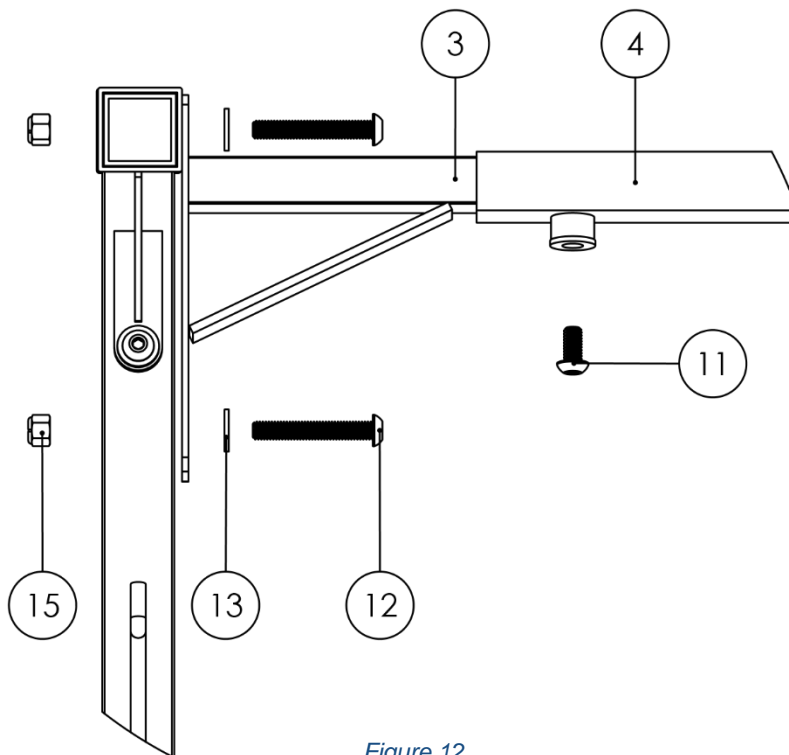

Figure 12

10. **Secure the position of the Siderails.** Locate the threaded hole found under the Female Siderail (Item No. 4). Finish securing the Siderails by threading a 3/4" Button Head Screw (Item No. 11) into this hole.



11. **Install the overhead Cargo Bumpers.** Secure the overhead Cargo Bumpers (Item No. 7) by threading a 1" Button Head Screw (Item No. 10) with a Metal Washer (Item No. 13).

12. **Replace the Crossbar End Caps.** Slide the Crossbar End Caps (Item No. 9) into the ends of each Crossbar.

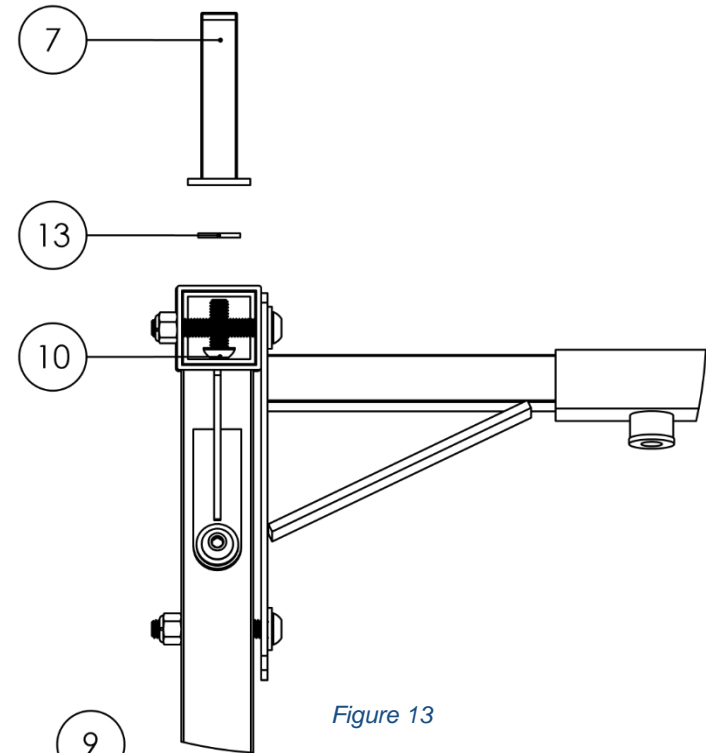

Figure 13

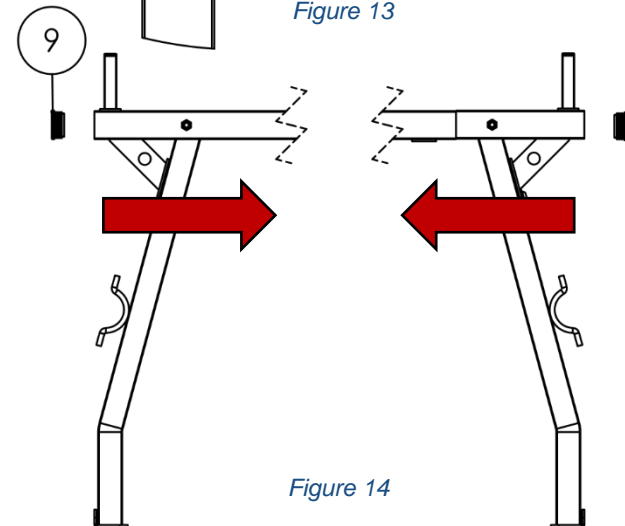

Figure 14



Stake Pocket Std. Rack (Ford / Dodge)

MADE IN THE USA

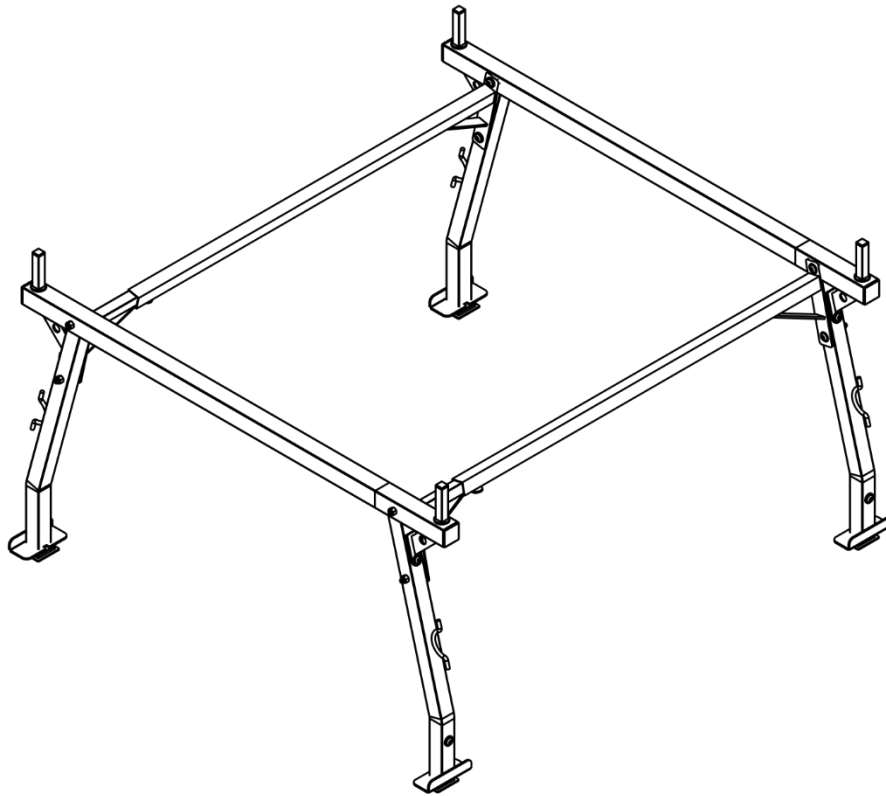

Figure 15

REMEMBER TO BE SAFE: Carrying any load can be hazardous. Avoid roll over. As with all racks, ensure that loads are not top-heavy. Loads should be placed so that the center of mass of the load is no closer than 24" from the sides of the rack. High loads must be transported with GREAT CAUTION to prevent loads from striking low overhead objects and from tipping during turns, abrupt stops, or high winds. Loads extending beyond the rear bumper of the vehicle must be designated with a red flag during daylight or red light during darkness in accordance with the state vehicle code.

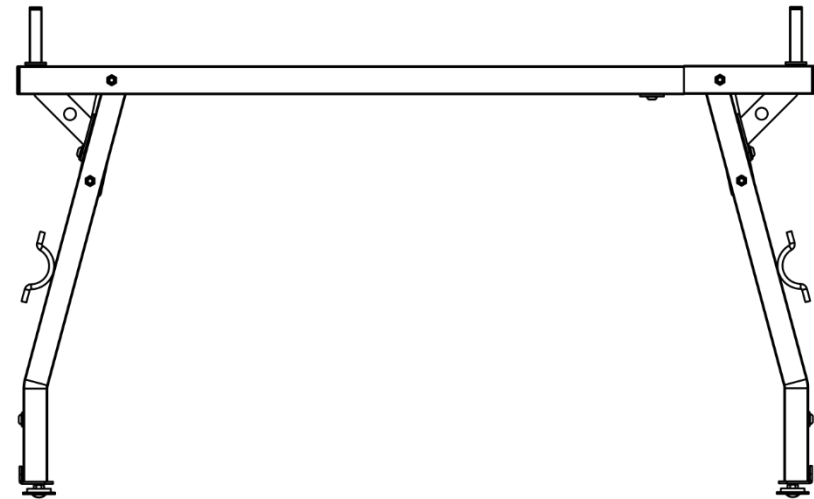

Figure 16

- 13. Tighten all screws and nuts on the rack firmly** with the Allen wrench. It is best to tighten each screw with increasing firmness as you move around to various fasteners so that you can check the alignment of the parts. When finished, all fasteners should be firmly tightened but not so firmly that the truck, rack components, or fasteners are stripped or damaged. When completed, the assembly should appear like what is shown above where all members of the rack are held rigidly together. Complete the assembly by applying horizontal pressure to the rack to ensure that the rack's base and the stake pocket components are unable to move. Frequently check the tightness of any threaded parts.